

Plan Th18-A

TOWNHOME

**1,427 SQ.FT.
3 STOREY**

2/3 BED
2.5 BATH



PARK SOUTH 
— *at* —
FISH CREEK EXCHANGE

Plan Th18-A

TOWNHOME

1,427 SQ.FT.
3 STOREY
2/3 BED
2.5 BATH

Featuring dual upper floor master suites and a private deck off the main floor dining area, this open-concept design makes optimal use of space.

- Convenient kitchen island with breakfast bar
- Attached tandem two-car garage
- Ample storage space throughout
- Walk-in master closets

Loaded with thoughtful features, this plan includes a full range of sought-after details that make home life a breeze.

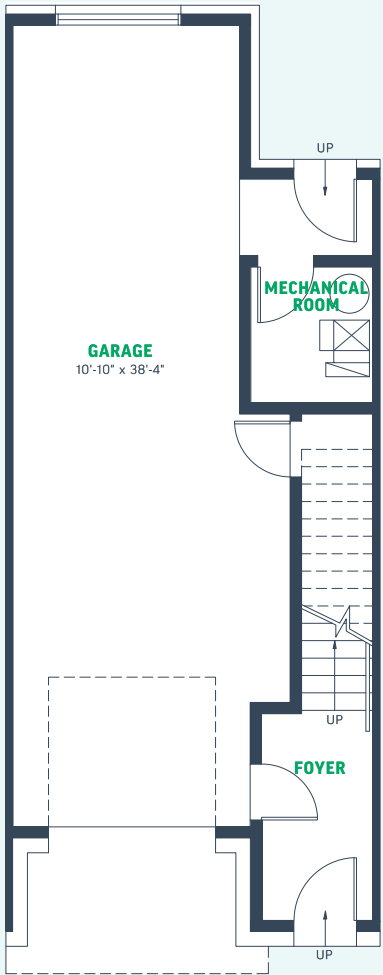

71 SQ.FT.
Entrance

SEE BACK FOR ENTRANCE OPTION

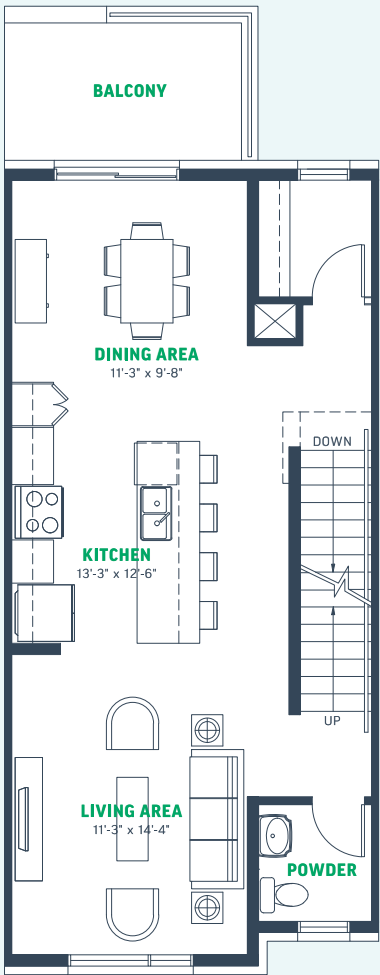

677 SQ.FT.
Main Floor

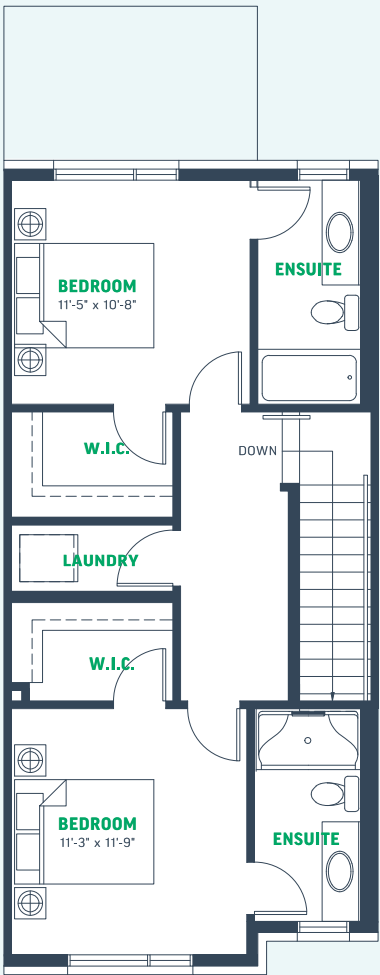

677 SQ.FT.
Upper Floor

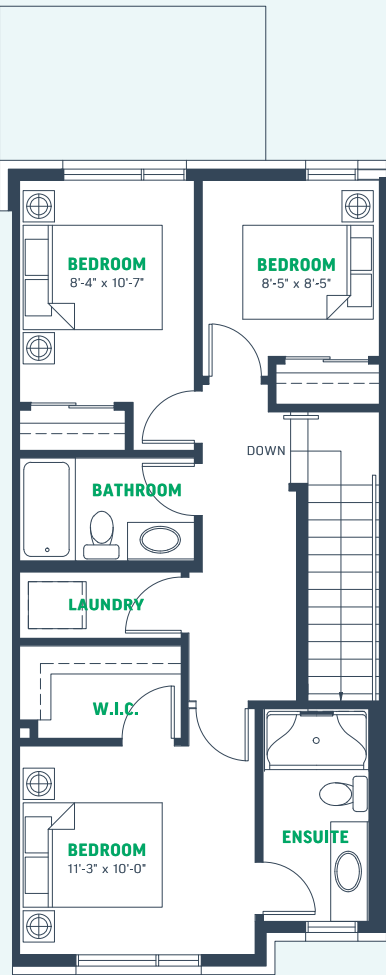

677 SQ.FT.
Upper Floor Option



North



BLOCK 18

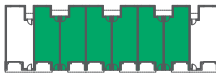

BLOCK 19



BLOCK 20

*The developer reserves the right to change plans, specifications, pricing, promotions, incentives, features, elevations, floor plans, designs, materials, amenities and dimensions without notice in its sole discretion. All renderings, colour schemes, floor plans, maps and displays are artists' conceptions and are not intended to be an actual depiction of the home or its surroundings. Homeowner association fees may be required. E&OE

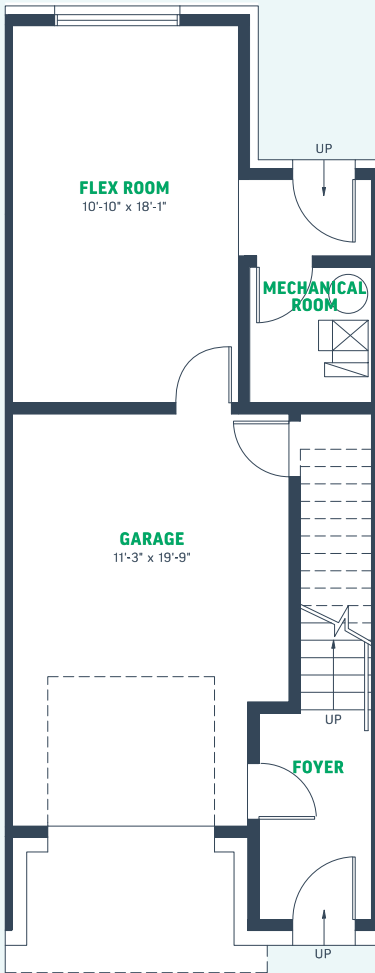

290 SQ.FT.

Entrance Option

PARK SOUTH 
 at
FISH CREEK EXCHANGE